



MODULAR DUAL LINE

Dual Line Lubrication Divider Valves Series 02

Series
02

PRODUCT DATA SHEET

ENGLISH

DESCRIPTION:

The modular dual line system consists of two main parts; the Base and the Metering Valves.

Bases and Metering Valves are made in stainless steel AISI 316 or in zinc plated steel and are available with inlets and outlets in UNI-ISO 7/1 (BSP) or NPTF threads.

The Metering Valves can be supplied with adjustable or fixed discharge. The Valves with adjustable discharge are fitted with turrets provided with integral adjusting screws together with a metacrylate cover and seal.

A blanking plate to be ordered separately, can be provided on the Base to accommodate future additional points.

The advantages of the Modular Dual Line System are:

- Versatility in lubrication layout planning.
- Flexibility to expand or reduce the number of elements to meet changing requirements.
- Reduced spare parts, fewer parts in stock = lower inventory costs.
- Blanking plates can be provided to accommodate future requirements.
- Save on labour and piping costs; the Metering Valves can be serviced without disturbing the assembly or existing pipework.
- Lower maintenance costs; the modular concept provides lower cost replacement components.

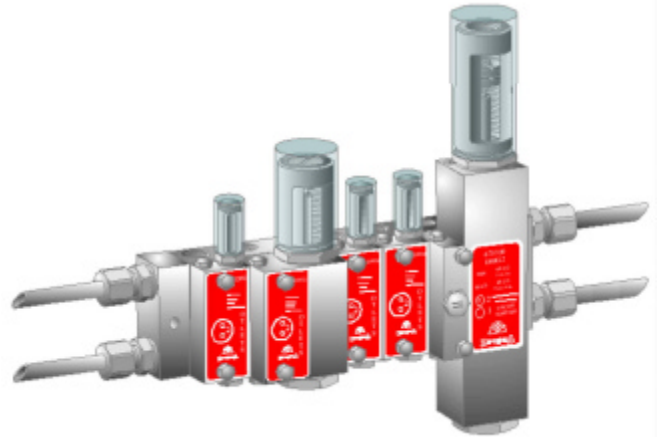

SPECIFICATION:

Temperature range:	-30°C to +80°C
Frequency:	100 cycles/minute.
Max. pressure (inlet):	400 bar
Lubricant:	
Oil:	15 cSt to 1000 cSt.
Grease:	NLGI 00 to NLGI 3.
Base threads:	
Inlets:	3/8" BSP or 3/8" NPTF.
Outlets:	1/4" BSP or 1/4" NPTF.

INSTALLATION/OPERATION:

The Base:

A modular base is made up of a minimum of three elements: inlet; intermediate and end.

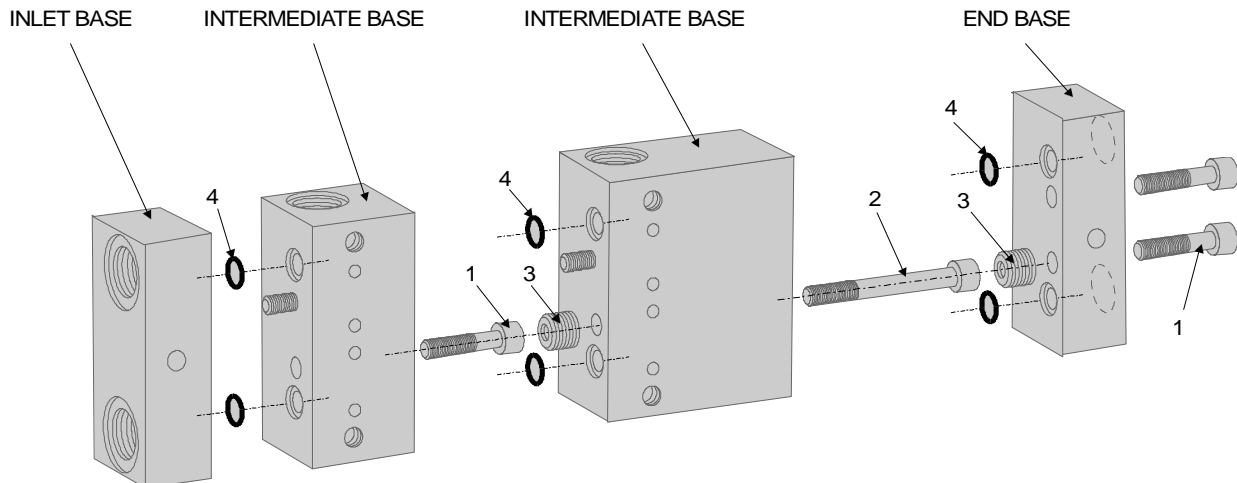

Key to Base Part Numbers.

Item	Description	Part No.	
		Zinc	St.Steel.
1	Screw	14090	675231
2	Screw	14095	675238
3	Thread insert	1523343	675217
4	'O' Ring (Viton)	18880	18880
5	Plug BSP	926001	519061
5	Plug NPTF	850304	519071
6	Check valve BSP	92313	519990
6	Check valve NPTF	92340	519901
7	Plug BSP	926002	519062
7	Plug NPTF	850305	519072

Base	BSP	NPTF
Inlet (zinc)	675311	675321
Intermediate (zinc) for valve: DMM-DM-DMMF-DMF- DMG-DMG1-DMG1-DMGF- DMGF1-DMGF2.	675312 675314	675322 675324
End (zinc)	675313	675323
Inlet (stainless)	675011	675071
Intermediate (stainless) for valve: DMMX-DMX-DMMXF- DMXF-DMGX-DMGX1- DMGX2-DMGX1-DMGX1- DMGX2	675012 675014	675072 675074
End (stainless)	675013	675073

Each element is made of zinc or stainless steel and is available with UNI-ISO 7/1 (BSP-DIN) or NPTF threads. This concept can be extended to include up to 20 or more sections in a common assembly and eliminate the need for costly pipe and tubing connections. The Base specified will accommodate its specific Metering Valves.

Metering Valves:

Metering Valves (adjustable)		
Discharge cu.in. (cm ³)	Zinc plated	
	Part No.	Mark
.006 - .061 (0,1 - 1)	675335	DMM
.015 - .183 (0,25 - 3)	675300	DM
.031 - 1.46 (0,5 - 24)	675310	DMG
.031 - 2.44 (0,5 - 40)	675320	DMG1
2.98 - 5.36 (49 - 88)	675330	DMG2
Blanking Plate	675305	DBP

Metering Valves (adjustable)		
Discharge cu.in. (cm ³)	St.Steel	
	Part No.	Mark
.006 - .061 (0,1 - 1)	675635	DMMX
.015 - .183 (0,25 - 3)	675600	DMX
.031 - 1.46 (0,5 - 24)	675610	DMGX
.031 - 2.44 (0,5 - 40)	675620	DMGX1
2.98 - 5.36 (49 - 88)	675630	DMGX2
Blanking Plate	675605	DBPX

Metering Valves (fixed)		
Discharge cu.in. (cm ³)	Zinc plated	
	Part No.	Mark
.061 (1)	675385	DMMF
.183 (3)	675301	DMF
1.46 (24)	675315	DMGF
2.44 (40)	675325	DMGF1
5.36 (88)	675345	DMGF2
Blanking Plate	675305	DBP

Metering Valves (fixed)		
Discharge cu.in. (cm ³)	St.Steel	
	Part No.	Mark
.061 (1)	675685	DMMXF
.183 (3)	675601	DMXF
1.46 (24)	675615	DMGXF
2.44 (40)	675625	DMGXF1
5.36 (88)	675645	DMGXF2
Blanking Plate	675605	DPBX

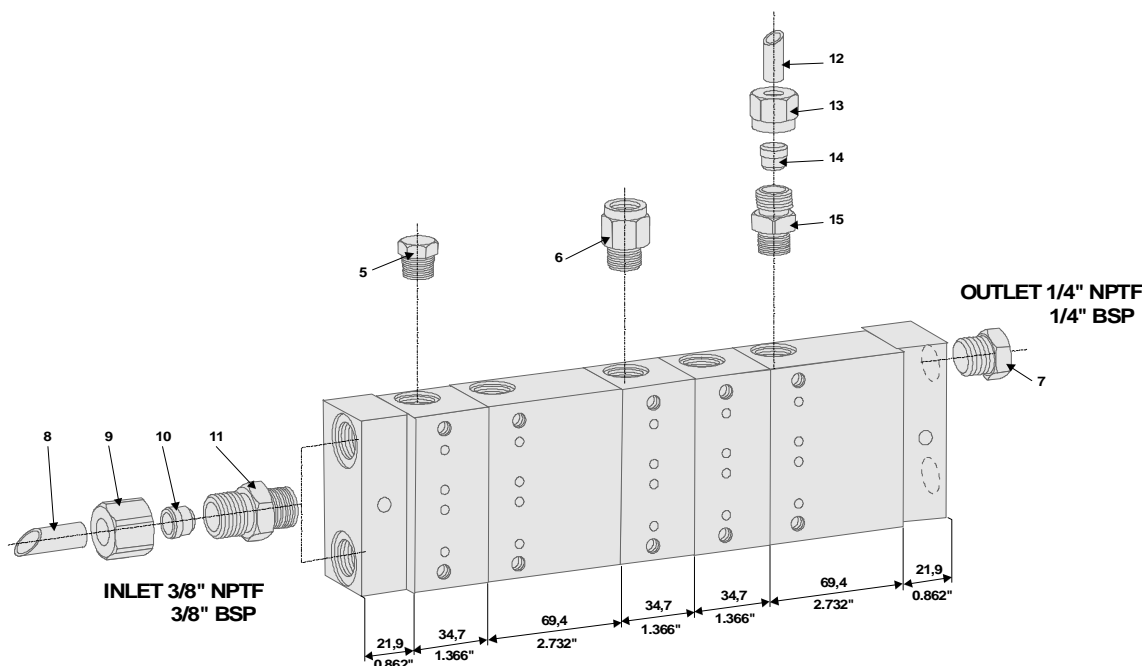

Turret cover:

Turret cover.	
Part No.	Mark
622207	DMM
622210	DMMX
671028	DM-DMX
675524	DMG-DMGX
675525	DMG1-DMGX1 DMG2-DMGX2

Base for valves	Value
DMM-DM-DMMF-DMF-DMMX- DMMXF-DMX-DMXF	34,7 mm. (1.366 in.)
DMG-DMGF-DMG1-DMGF1- DMG2-DMGF2-DMGX-DMGF- DMGX1-DMGX1-DMGX2- DMGX2	69,4 mm. (2.732 in.)

Dimensions:

(Values in parenthesis are for fixed discharge).

Dimension 'A' is obtained by adding to the dimensions of the Base Inlet and Base End 43,8 mm. (1.725") the following values for each Intermediate Base

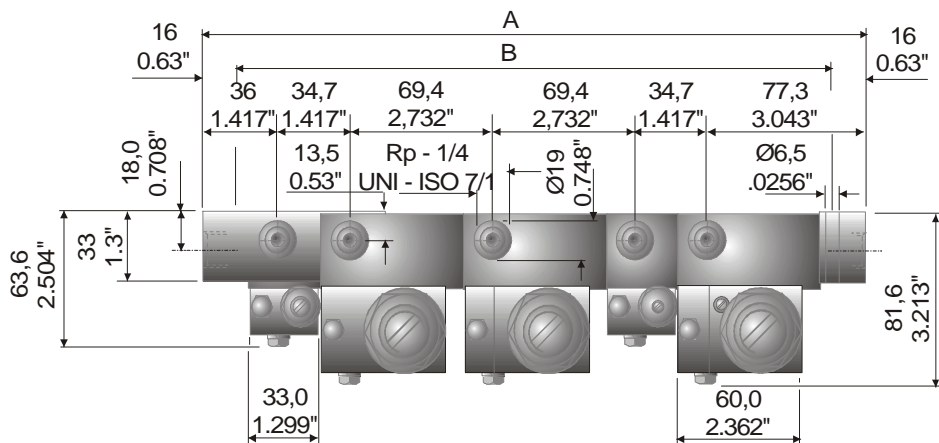
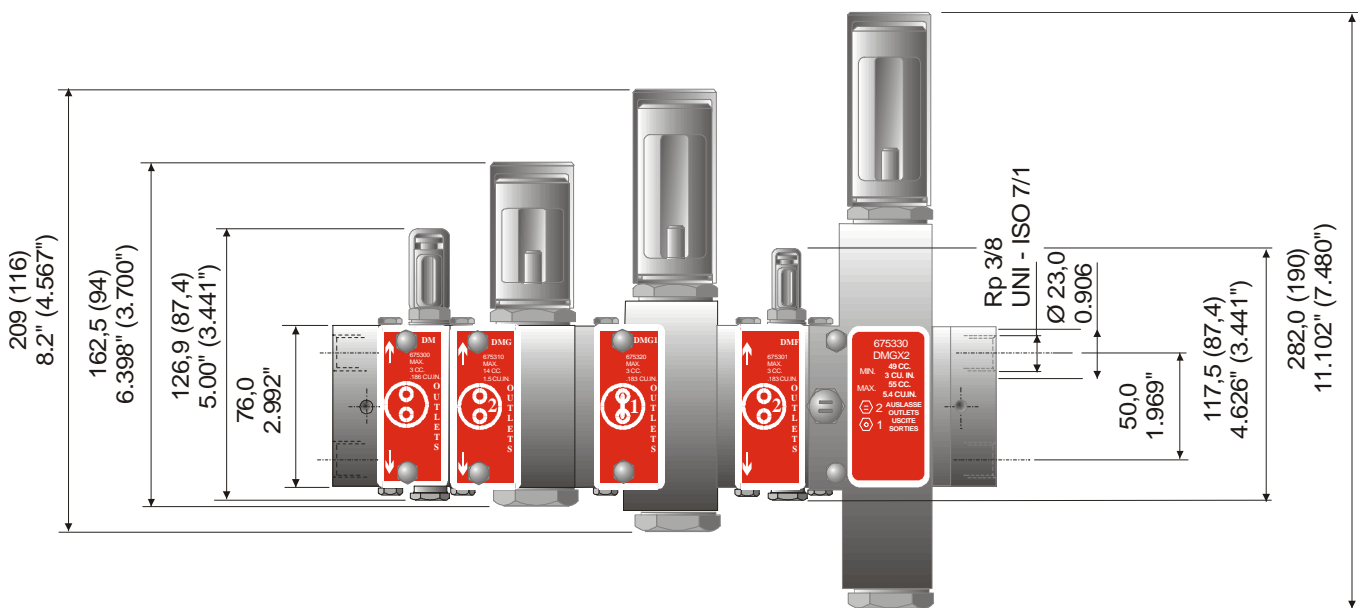

Spares:

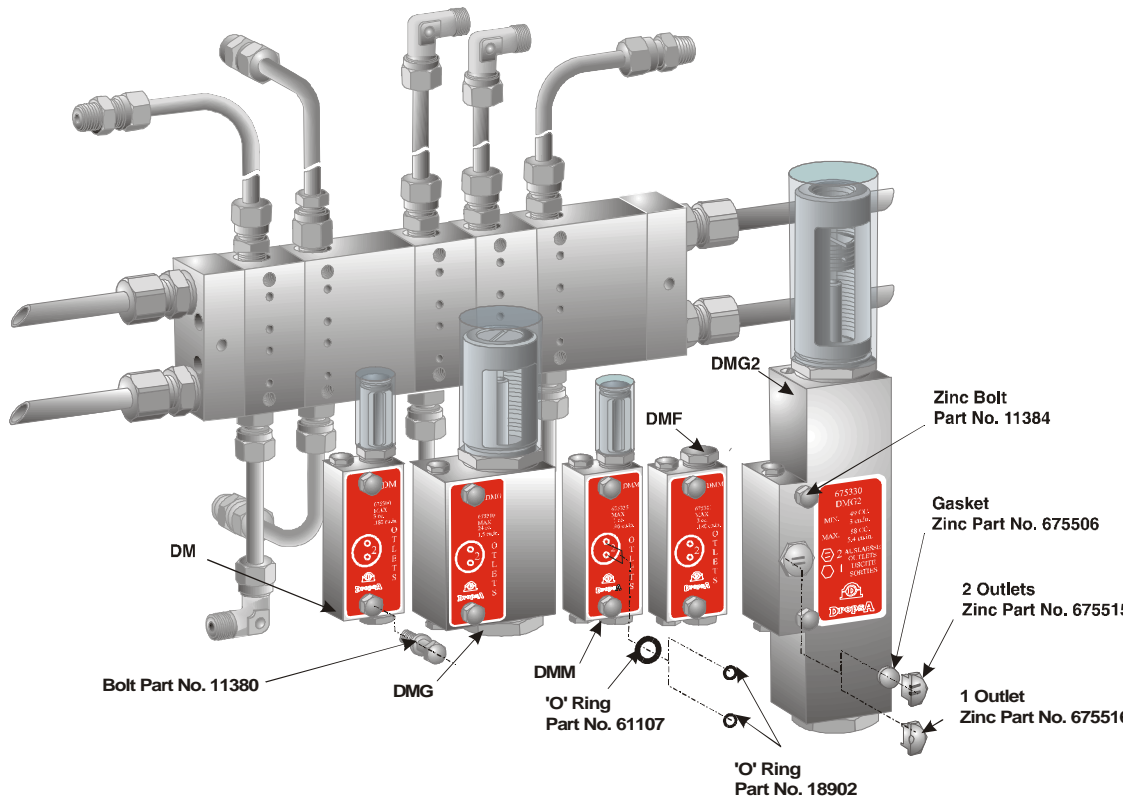

ORDERING INFORMATION:

Refer to the following ordering menu:

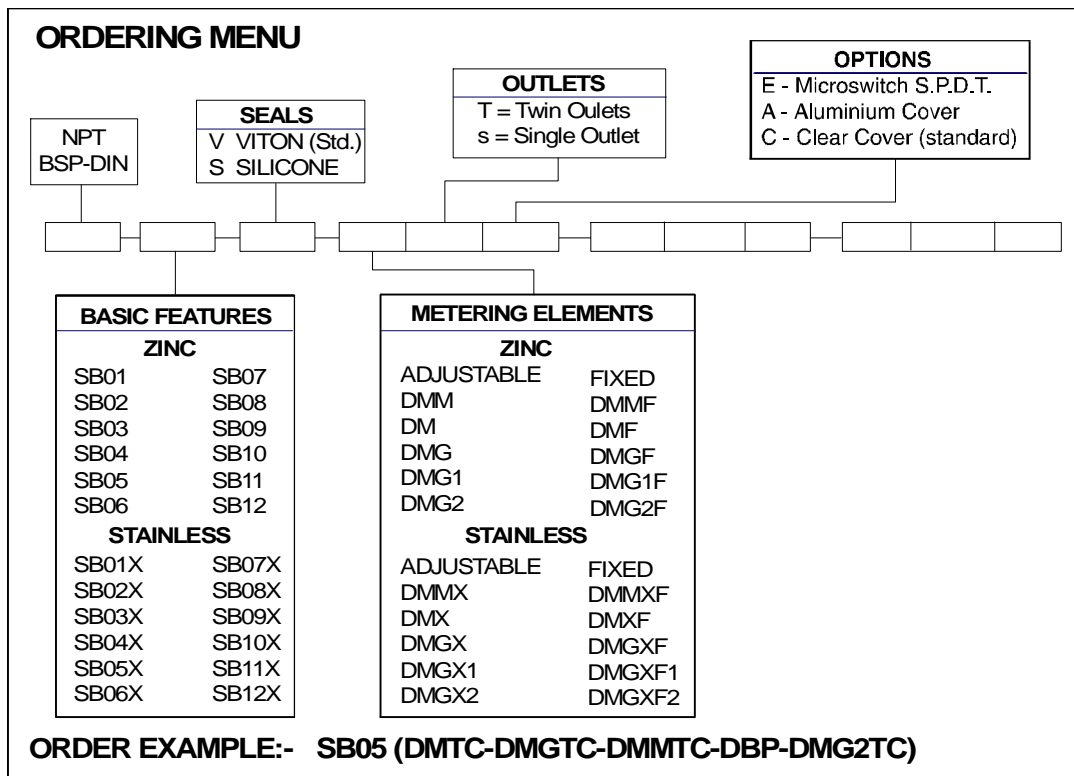

U.K.
Dropa (UK) Ltd.
Unit 6, Egham Business Village,
Egham,
Surrey, TW20 8RB
Tel: (+44) 01784 - 431177
Fax: (+44) 01784 - 438598
E-mail: salesuk@dropsa.com

U.S.A.
Dropa USA Inc.
50679 Wing Drive
Utica,
Michigan 48315,
Tel: (+1) 810-566-1540
Fax: (+1) 810-566-1541
E-mail: salesusa@dropsa.com

AUSTRALIA
Dropa Australia Pty.
No. 7 Warringah Road
Dee Why
NSW 2099
Tel: (+61) 2 9905 0410
Fax: (+61) 2 99394142
E-mail: sales@dropsa.com

GERMANY
Dropa GmbH.
Volmerswerther Strasse 80
40221 Dusseldorf 1,
Deutschland
Tel: (+49) 0211-394-011
Fax: (+49) 0211-394-013
E-mail: sales@dropsa.de

ITALY
Dropa Spa
Via B. Croce, 1 - 20090
Vimodrone (MI)
Tel: (+39) 02 - 250.79.1
Fax: (+39) 02 - 250.79.767
E-mail: sales@dropsa.it (Export)
E-mail: vendite@dropsa.it (National)

© Copyright Dropa - all rights reserved. Reproduction of any part of this document is strictly forbidden without prior consent from Dropa. Dropa reserves the right to modify specifications without prior notice.